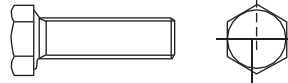

HSN CODE : 73181500

**HEX HEAD BOLT / HEX HEAD SCREW**  
**DIN 933 / IS : 1364-1992 / ISO 4017****Fully Threaded - A2 70**  
**Metric - SS 304**

D \ L	10	12	16	20	25	30	35	40	45	50	55	60	65	70	75	80	85	90	100
3	188	206	215	239	274	432	520	643	730	748	-	-	-	-	-	-	-	-	-
4	237	244	265	294	330	394	458	628	675	703	957	1011	1071	1132	1198	1267	1337	1407	1547
5	325	346	371	416	469	536	624	740	810	866	1576	1770	1977	2074	2191	2377	2690	2865	3266
6	456	479	527	576	656	741	810	887	971	1035	1206	1264	1376	1443	1596	1657	1849	1889	2103
8	-	-	1051	1154	1294	1471	1583	1716	1910	2020	2197	2292	2500	2573	2692	3005	3168	3315	3633
10	-	-	2035	2103	2323	2515	2771	2993	3237	3489	3724	3953	4255	4380	4706	4903	5272	5394	5772
12	-	-	-	3231	3435	3675	4042	4434	4730	5096	5366	5684	5986	6287	6642	6953	7353	7668	8308
14	-	-	-	-	5971	6331	6803	7179	7695	8134	8720	9015	9681	10046	10535	11041	12013	12622	12992
16	-	-	-	-	7375	7600	8186	8778	9335	9958	10558	11220	11660	11983	12670	13486	14012	14710	16014
18	-	-	-	-	-	-	-	13313	14330	14888	16121	16749	17789	18424	19467	20230	21056	21721	22927
20	-	-	-	-	-	-	-	15202	16342	17169	17839	18791	19894	21038	21841	22878	23953	25020	26935
22	-	-	-	-	-	-	-	22498	23895	25477	26741	28138	29364	30443	32169	33783	36019	37224	44509
24	-	-	-	-	-	-	-	27082	28409	29427	30332	31903	33417	35082	36511	38062	39874	41690	45042

All dimensions are in mm

HSN CODE : 73181500

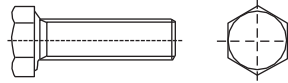
**HEX HEAD BOLT / HEX HEAD SCREW**  
**DIN 933 / IS : 1364-1992 / ISO 4017****Fully Threaded - A2 70**  
**Metric - SS 304**

D \ L	110	120	125	130	140	150	160	170	180	200	225
8	4028	4326	4478	4699	5097	5408	-	-	-	-	-
10	6463	7089	7384	7585	8059	8904	10787	-	-	-	-
12	9107	9873	10367	10904	11499	12385	13201	19484	21241	25332	-
16	17376	18748	19370	19953	21184	22777	24416	27570	30134	32833	-
20	30176	32068	33050	34214	36256	38406	40152	42246	44167	48583	96170
22	47649	49285	-	51265	53411	55744	-	-	-	-	-
24	49942	53272	54963	56765	60046	63341	66590	69718	73155	79908	-

All dimensions are in mm

HSN CODE : 73181500

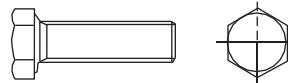
**HEX HEAD BOLT / HEX HEAD SCREW**  
**BS-1083 / 1965****Full Threaded - A2**  
**Inch ( ) - SS 304**

D \ L	1/2"	3/4"	1"	1.1/4"	1.1/2"	2"	2.1/2"	3"	3.1/2"	4"	5"	6"	7"	8"
1/8"	277	299	322	545	676	758	-	-	-	-	-	-	-	-
3/16"	310	359	409	491	631	784	1134	1363	-	-	-	-	-	-
1/4"	609	700	809	918	1038	1260	1610	1864	2028	2301	-	-	-	-
5/16"	1079	1232	1413	1591	1776	2127	2497	2867	3364	3934	4779	-	-	-
3/8"	1684	1917	2168	2437	2706	3237	3765	4299	4823	5361	7063	8548	-	-
7/16"	-	-	3981	4414	4796	5583	6413	7246	8062	8847	10561	12100	-	-
1/2"	-	-	4578	5076	5515	6420	7375	8332	9272	10174	12145	13915	20165	24258
5/8"	-	-	8474	8674	9374	10921	12244	14413	15116	16484	20498	23599	29008	32750
3/4"	-	-	-	-	17379	19169	21500	23862	26200	28647	37498	42855	-	-

All dimensions are in inches

HSN CODE : 73181600

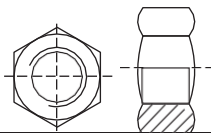
**HEX NUT**  
**DIN 934 / IS : 1364 P3-2002 / ISO 4032****Metric - SS 304 - A2 70**

I A	M2	M2.5	M3	M4	M5	M6	M8	M10	M12	M14	M16	M18	M20	M 22	M 24	M 27	M 30	M 33	M 36
304Q	162	193	94	120	143	243	481	1077	1614	2570	3307	6336	6336	10686	10686	23859	35612	41278	57089

All dimensions are in mm

**TRADE DISCOUNTS AND TAXES APPLY**Visit us at <https://agarwalfasteners.in>

**HEX NUT  
BS-1083/1965**

HSN CODE : 73181600

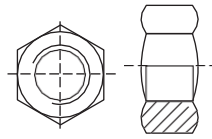

Inch () - SS 304 - A2

DIA	1/8"	5/32"	3/16"	1/4"	5/16"	3/8"	7/16"	1/2"	5/8"	3/4"		
304Q	158	166	182	369	540	913	1913	2396	4347	8507		

All dimensions are in inches

**PLAIN WASHER  
DIN 125/IS:2016-1967/ISO 7089**

HSN CODE : 73182200

**SPRING WASHER  
DIN 127/IS:3063-1927**

HSN CODE : 73182100

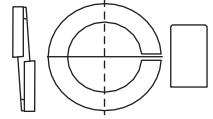

THICK	1.2MM	1.6MM	2MM	2.5MM	3MM	IS
M3 (1/8")	90	-	-	-	-	90
M4 (5/32")	100	-	-	-	-	100
M5 (3/16")	125	160	-	-	-	125
M6 (1/4")	160	260	325	375	400	260
M8 (5/16")	240	350	400	600	690	350
M10 (3/8")	350	490	650	800	1100	650
M12 (1/2")	410	650	875	1300	1550	1300
M14 (9/16")	760	1030	1375	1540	1850	1850
M16 (5/8")	800	1185	1545	1885	2150	2150
M18	1100	1375	1900	2300	2675	2675
M20 (3/4")	1150	1500	2000	2400	2850	2850
M22 (7/8")	-	-	2150	-	3350	3350
M24 (1")	1700	1950	2650	-	4800	6600
M27	-	-	-	-	5200	6900
M30	-	-	-	-	6750	8300
M33	-	-	-	-	8300	10500
M36	-	-	-	-	8500	13600

All dimensions are in mm

All dimensions are in inches

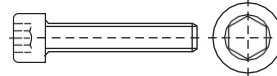
**ALLEN CAP BOLT  
DIN 912 / ISO 4762**

HSN CODE : 73181500

**Fully Threaded - A2 70  
Metric - SS 304**

D	L	6	8	10	12	16	20	25	30	35	40	45	50	60	70	75	80	90	100
3		364	354	363	371	415	459	530	693	-	-	-	-	-	-	-	-	-	-
4		445	422	392	403	464	520	560	680	765	922	1090	1246	1757	2336	2709	3083	4038	5249
5		-	528	520	550	616	691	775	893	1019	1191	1317	1444	2095	2534	2787	3041	3649	4378
6		-	-	708	715	799	867	970	1056	1166	1317	1441	1521	1920	2245	2500	2836	3223	3789
8		-	-	1618	1725	1568	1639	1814	2079	2267	2433	2649	2807	3346	3700	4325	4561	5303	5691
10		-	-	-	-	3132	2898	3255	3435	3814	4083	4368	4695	5297	6015	6361	6709	8252	9068
12		-	-	-	-	-	5616	5347	5454	5793	6243	6778	7154	8060	8603	9410	10128	10982	12063
14		-	-	-	-	-	-	13342	13483	14100	14723	15793	16616	18373	20698	23372	23960	26740	29471
16		-	-	-	-	-	-	-	12659	11797	12912	13986	14471	16183	17982	19090	19933	21888	23901
20		-	-	-	-	-	-	-	-	-	24591	25568	27023	30063	32937	34673	36138	39056	42445
24		-	-	-	-	-	-	-	-	-	42517	44822	46408	51919	55592	57836	60047	64742	69921

All dimensions are in mm

**ALLEN CAP BOLT  
DIN 912 / ISO 4762**

HSN CODE : 73181500

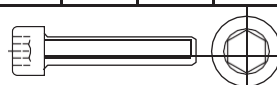
**Fully Threaded - A2 70  
Metric - SS 304**

D	L	110	120	125	130	140	150				
8		6588	7097	7781	8258	-	-				
10		10916	11761	12299	12518	-	16234				
12		16017	17128	17834	18158	19880	21186				
16		29969	32103	34220	-	-	39977				
20		50072	50932	53243	55396	58473	61622				

TRADE DISCOUNTS AND TAXES APPLY

Visit us at <https://agarwalfasteners.in>

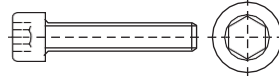
**ALLEN CAP BOLT  
BS 2470****Fully Threaded - A2  
Inch () - SS 304**

HSN CODE : 73181500

D \ L	1/2"	3/4"	1"	1.1/4"	1.1/2"	2"	2.1/2"	3"	3.1/2"	4"
3/16"	766	784	847	943	1095	-	-	-	-	-
1/4"	1024	1109	1230	1387	1594	1935	2448	3108	3794	4274
5/16"	1751	1844	1921	2245	2462	2905	3751	4443	-	-
3/8"	-	2712	2860	3216	3643	4438	5363	6432	7320	7967
1/2"	-	-	-	7160	7863	8831	10243	11489	13893	16142
5/8"	-	-	-	-	14018	16128	19154	22606	26369	28176

All dimensions are in inches

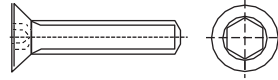
**ALLEN CSK  
DIN 7991 / IS:6761-1972****Fully Threaded - A2 70  
Metric - SS 304**

HSN CODE : 73181500

D \ L	6	8	10	12	16	20	25	30	35	40	50	60	70	80	90	100
3	126	126	133	154	196	270	348	-	-	-	-	-	-	-	-	-
4	192	182	200	207	245	305	354	418	480	563	-	-	-	-	-	-
5	303	288	276	304	364	431	522	613	701	793	980	-	-	-	-	-
6	-	-	446	473	551	647	761	895	1008	1143	1373	1658	2076	2691	3070	3706
8	-	-	-	-	1147	1198	1457	1679	1935	2133	2519	2961	3329	3776	4410	4741
10	-	-	-	-	-	2426	2622	2910	3146	3711	4149	5037	5555	6492	6877	7820
12	-	-	-	-	-	-	4246	4819	5148	5459	6526	7860	9205	10007	11050	12231
16	-	-	-	-	-	-	-	-	-	10569	12103	14158	16313	18760	20559	22400

All dimensions are in mm

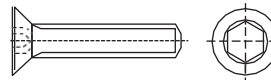
**ALLEN CSK  
BS 84****Fully Threaded - A2  
Inch () - SS 304**

HSN CODE : 73181500

D \ L	1/2"	3/4"	1"	1.1/4"	1.1/2"	2"	2.1/2"	3"		
3/16"	800	950	1050	1150	1350	1500	-	-		
1/4"	1000	1000	1150	1250	1450	1650	2050	-		
5/16"	-	2300	2500	2650	3050	3450	4050	4850		
3/8"	-	3800	3800	4000	4600	5200	6000	7200		
1/2"	-	-	8200	9000	12000	16000	19000	20000		

All dimensions are in inches

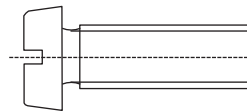
**SLOTTED CHEESE HD SCREW  
DIN 84 / IS:1366-1982 / ISO 1207  
ROUND HD SCREW****Fully Threaded - A2 70  
Metric - SS 304**

HSN CODE : 73181500

**PAN HEAD SCREW  
DIN 85 / IS:6101-1982 / ISO : 1580**

D \ L	4	6	8	10	12	16	20	25	30	35	40	50	60	70	80	90	100
2	173	165	165	173	180	213	251	-	-	-	-	-	-	-	-	-	-
2.5	180	173	182	200	213	243	289	402	-	-	-	-	-	-	-	-	-
3	-	186	182	195	213	246	311	389	568	731	-	-	-	-	-	-	-
4	-	266	274	288	313	356	408	484	564	631	739	914	-	-	-	-	-
5	-	393	409	435	485	541	611	707	806	912	1043	1266	-	-	-	-	-
6	-	-	-	643	679	798	879	1052	1176	1351	1500	1793	2139	2432	2753	-	-
8	-	-	-	-	-	1971	2230	2371	2681	2933	3304	3922	4087	4553	4996	-	-
10	-	-	-	-	-	-	3465	3883	4373	4862	5304	6206	7273	8383	9271	10292	10948

All dimensions are in mm

**TRADE DISCOUNTS AND TAXES APPLY**Visit us at <https://agarwalfasteners.in>

**SLOTTED CHEESE HD SCREW  
BS 450  
ROUND HEAD SCREW**

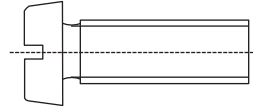

**Fully Threaded - A2 70  
- SS 304**

HSN CODE : 73181500

D \ L	1/4"	3/8"	1/2"	3/4"	1"	1.1/4"	1.1/2"	2"	2.1/2"	3"
1/8"	199	219	244	298	380	600	760	1141	-	-
5/32"	248	280	314	393	461	540	726	920	-	-
3/16"	-	386	447	551	672	793	919	1152	-	-
1/4"	-	750	812	995	1179	1403	1580	2015	2515	2940
5/16"	-	-	1803	2081	2373	2701	3055	3945	4746	5626
3/8"	-	-	2905	3195	3586	4432	4874	5991	7143	8816

All dimensions are in inches

**PAN PHILIPS SCREW  
DIN 7985 / IS:7483-1985 / ISO 7045**

HSN CODE : 73181500

**Fully Threaded - A2 70  
Metric - SS 304**

D \ L	4	6	8	10	12	16	20	25	30	35	40	50	60	70	80	90	100
2	141	135	135	141	147	174	207	-	-	-	-	-	-	-	-	-	-
2.5	147	141	149	163	174	199	236	329	-	-	-	-	-	-	-	-	-
3	-	134	132	147	164	187	235	294	429	552	538	768	-	-	-	-	-
4	-	214	234	240	261	289	335	407	474	523	624	774	-	-	-	-	-
5	-	333	332	360	392	438	523	597	694	789	896	1057	-	-	-	-	-
6	-	-	-	500	549	616	720	835	961	1177	1243	1504	1863	2118	2397	2519	2830
8	-	-	-	-	-	1643	1860	1977	2236	2446	2756	3270	3412	3801	4172	4689	5243
10	-	-	-	-	-	-	2890	3240	3649	4056	4425	5177	6067	6990	7729	8579	9125

All dimensions are in mm

**BUTTON HEAD SCREW  
ISO 7380**

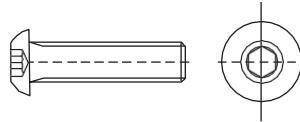

**Fully Threaded - A2 70  
Metric - SS 304**

HSN CODE : 73181500

D \ L	6	8	10	12	16	20	25	30	35	40	50	60
3	154	154	157	177	222	266	301	-	-	-	-	-
4	195	195	194	219	265	324	378	435	530	641	-	-
5	309	309	313	327	394	466	544	648	754	808	-	-
6	-	-	417	455	543	650	757	891	1045	1173	1420	-
8	-	-	-	-	1176	1279	1513	1764	1954	2256	2586	2980
10	-	-	-	-	-	2581	2862	3355	3710	3878	4417	5276

All dimensions are in mm

**CSK PHILIPS SCREW  
DIN 965 / IS:7485-1985 / ISO 7047**

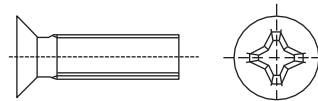

**Fully Threaded - A2 70  
Metric - SS 304**

HSN CODE : 73181500

D \ L	4	6	8	10	12	16	20	25	30	35	40	50	60	70	80	90	100
2	143	135	135	142	145	173	208	-	-	-	-	-	-	-	-	-	-
2.5	145	142	150	163	173	207	237	274	-	-	-	-	-	-	-	-	-
3	-	125	113	127	138	161	211	267	400	528	-	-	-	-	-	-	-
4	-	179	183	190	205	243	293	361	424	468	573	717	-	-	-	-	-
5	-	239	245	250	273	344	409	502	583	673	793	976	-	-	-	-	-
6	-	-	-	424	438	507	589	697	834	968	1082	1353	1661	1922	2119	-	-
8	-	-	-	-	-	1353	1534	1735	1972	2201	2478	3045	3537	4028	4645	-	-
10	-	-	-	-	-	-	2393	2712	3129	3526	3952	4790	5489	6684	7489	8527	9199
12	-	-	-	-	-	-	4091	4360	4888	5244	6050	7255	8233	8665	10242	11427	12476

All dimensions are in mm

**TRADE DISCOUNTS AND TAXES APPLY**

Visit us at <https://agarwalfasteners.in>

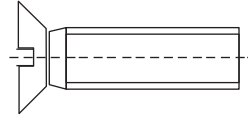
**SLOTTED COUNTERSUNK HEAD SCREW**  
**DIN 963 / IS:1365-1978 / ISO 2009**

**Fully Threaded - A2 70**  
**Metric - SS 304**

HSN CODE : 73181500

D \ L	4	6	8	10	12	16	20	25	30	35	40	50	60	70	80	90	100
2	175	165	165	173	177	211	253	-	-	-	-	-	-	-	-	-	-
2.5	177	173	183	200	211	252	289	335	-	-	-	-	-	-	-	-	-
3	-	166	156	175	200	219	319	363	539	700	-	-	-	-	-	-	-
4	-	229	219	241	251	299	361	429	505	558	687	937	-	-	-	-	-
5	-	307	296	321	355	426	507	601	714	827	950	1173	-	-	-	-	-
6	-	-	-	502	539	598	728	854	998	1159	1296	1620	1989	2301	2538	-	-
8	-	-	-	-	-	1642	1861	2104	2390	2668	3003	3691	4287	4881	5630	-	-
10	-	-	-	-	-	-	2871	3252	3752	4228	4740	5745	6583	8018	8985	10230	11036
12	-	-	-	-	-	-	4962	5286	5924	6353	7330	8791	9973	10496	12407	13842	15112

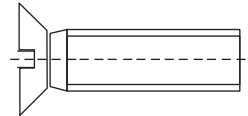
All dimensions are in mm

**SLOTTED COUNTERSUNK HEAD SCREW**  
**BS 450/1958**

**Fully Threaded - A2 70**  
**Inches ( ) - SS 304**

HSN CODE : 73181500

D \ L	1/4"	3/8"	1/2"	3/4"	1"	1.1/4"	1.1/2"	2"	2.1/2"	3"	3.1/2"	4"
1/8"	179	200	232	275	366	588	747	1129	-	-	-	-
5/32"	210	247	285	361	449	519	690	894	-	-	-	-
3/16"	-	301	343	447	602	756	875	1091	-	-	-	-
1/4"	-	553	682	818	981	1199	1357	1795	2358	2775	-	-
5/16"	-	-	1617	1929	2198	2663	3012	3842	4678	5546	-	-
3/8"	-	-	2864	2822	3208	3948	4317	5424	6471	8311	-	-
1/2"	-	-	-	-	6132	7496	8548	10518	12506	14198	16436	22138

All dimensions are in inches

**HEX THIN NUT / LOCK NUT**  
**DIN 439 / IS : 1364 / ISO : 4035**

**A2 35**  
**Metric - SS 304**

HSN CODE : 73181600

§ ZE	M 5	M 6	M 8	M 10	M 12	M 14	M 16	M 20	M 24	M 27	M 30	M 33	M 36
304	148	182	347	736	1068	2022	2133	4605	8543	20644	29601	38895	50907

All dimensions are in mm

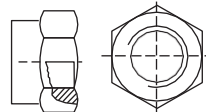
**NYLOCK NUT**  
**DIN 982 / IS:7002-1972 / ISO 7040**

**A2 70**  
**Metric - SS 304**

HSN CODE : 73181600

§ ZE	M 3	M 4	M 5	M 6	M 8	M 10	M 12	M 16	M 20	M 24	M 30		
304	262	258	329	492	871	1653	2571	5646	18468	56846	103108		

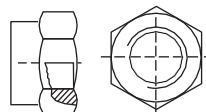
All dimensions are in mm

**NYLOCK NUT**

**A2 70**  
**Inch ( ) - SS 304**

HSN CODE : 73181600

BSW	3/16"	1/4"	5/16"	3/8"	1/2"	5/8"	3/4"
304	1200	1350	2020	3300	5800	9850	18800

All dimensions are in inches

**TRADE DISCOUNTS AND TAXES APPLY**

 Visit us at <https://agarwalfasteners.in>

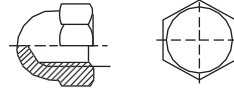
**DOM NUT**  
**DIN 1587/IS:7790****A2 70**  
**Metric - SS 304**

HSN CODE : 73181600

SIZE	M 3	M 4	M 5	M 6	M 8	M 10	M 12	M 16	M 20	M 24
304	370	385	463	622	1220	2582	3792	8351	15799	46136

All dimensions are in mm

**DOME BOLT****Fully Threaded - A2 70**  
**Metric - SS 304**

HSN CODE : 7318

D	L	10 mm	12 mm	16 mm	20 mm	25 mm	30 mm	35 mm	40 mm	50 mm
5 mm		1600	1700	1950	2050	2200	2350	-	-	-
6 mm		2150	2250	2300	2400	2500	2600	2750	3200	3350
8 mm		-	-	3400	3600	3700	3850	4000	4300	4600
10 mm		-	-	-	8050	8500	9000	9500	10000	12000

All dimensions are in mm

**STUD (ONE METER LONG) DIN 975**

HSN CODE : 73181900

**A2 70**  
**Metric - SS 304**

SIZE	M 4	M 5	M 6	M 8	M 10	M 12	M 14	M 16	M 20	M 24
304	14467	15005	16162	27771	43654	63728	87752	115897	185096	269231

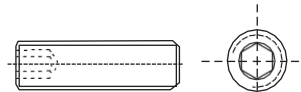
**ALLEN GRUB SCREW**  
**DIN 916 / IS:6094-1981 (CP) ISO 4029****Fully Threaded - A2 70**  
**Metric - SS 304**

HSN CODE : 73181500

D	L	3	4	5	6	8	10	12	16	20	25	30	35	40	45	50	55	60	65
3		142	128	132	142	164	195	267	534	711	-	-	-	-	-	-	-	-	-
4		192	151	159	174	210	237	285	385	502	686	916	-	-	-	-	-	-	-
5		256	184	192	219	275	331	385	530	686	988	1234	1554	1968	-	-	-	-	-
6		-	290	255	265	335	414	502	687	880	1172	1471	1761	2202	2819	3523	-	-	-
8		-	-	-	485	573	706	880	1233	1586	2115	2642	3039	3479	4097	4845	5639	6092	-
10		-	-	-	846	846	1018	1255	1780	2329	3050	3768	4574	5505	6352	7201	8046	9317	-
12		-	-	-	-	1524	1566	2551	2625	3430	4447	5463	6606	7623	8892	10164	11435	13127	16939
16		-	-	-	-	-	-	6098	6775	7877	8892	10587	12281	13976	15247	16939	18634	20751	-

All dimensions are in mm

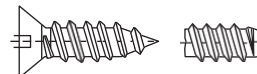
**CSK PHILIPS & CSK SELF TAPPING SCREW**  
**DIN 7972 / IS 7170 - 1974 / ISO 1482****Fully Threaded - A2 70**  
**SS 304**

HSN CODE : 73181400

No.	L	6.5	9.5	13	16	19	25	32	38	50	60	75	100
4		109	124	140	158	-	-	-	-	-	-	-	-
6		132	153	170	197	232	295	349	-	-	-	-	-
8		-	200	229	263	290	362	450	535	785	1021	1327	1857
10		-	261	287	316	377	471	553	673	987	1382	1797	2426
12		-	389	428	493	558	695	864	870	1171	1522	2130	2983
14		-	-	-	621	722	903	1152	1321	1922	-	-	-

All dimensions are in mm

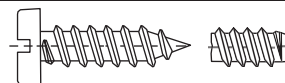
**PAN PHILIPS & PAN HEAD SELF TAPPING SCREWS**  
**DIN 7981 / ISO 7049****Fully Threaded - A2 70**  
**SS 304**

HSN CODE : 73181400

No.	L	6.5	9.5	13	16	19	25	32	38	50	60	75	100
4		128	139	148	167	214	-	-	-	-	-	-	-
6		165	185	199	226	264	320	376	-	-	-	-	-
8		-	251	278	316	346	411	496	586	821	1068	1388	1944
10		-	331	363	424	470	557	664	769	913	1282	1666	2249
12		-	507	558	620	616	812	987	1137	1355	1762	2467	3453
14		-	-	-	826	904	1101	1315	1464	1959	-	-	-

All dimensions are in mm

**TRADE DISCOUNTS AND TAXES APPLY**Visit us at <https://agarwalfasteners.in>

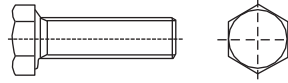
**HEX HEAD BOLT / HEX HEAD SCREW  
DIN 933 / IS : 1364-1992 / ISO 4017**

HSN CODE : 73181500

**Fully Threaded - A4 70  
Metric - SS 316**

D \ L	10	12	16	20	25	30	35	40	45	50	55	60	65	70	75	80	85	90	100
6	780	795	898	1016	1134	1266	1399	1528	1693	1840	2021	2130	2349	2475	2670	2783	3126	3201	3509
8	-	-	1840	2055	2289	2533	2775	3012	3294	3498	3783	3987	4307	4469	4704	5013	5427	5618	6051
10	-	-	3495	3826	4187	4540	4885	5274	5648	6046	6433	6830	7351	7567	8129	8366	9000	9172	9806
12	-	-	-	5700	6184	6723	7300	7858	8197	8976	9305	10085	10378	11191	11793	12354	12730	13539	14678
14	-	-	-	-	9528	10152	10906	11507	12326	13041	13977	14487	15516	16124	16945	17746	19305	20297	20875
16	-	-	-	-	12409	13049	14058	15074	16029	17103	18129	19270	20027	21091	21898	23388	24466	25470	27301
20	-	-	-	-	-	-	-	25953	27900	29313	30456	32082	33818	35753	37289	39060	40582	42227	45287
22	-	-	-	-	-	-	-	34669	36822	39259	41208	43359	45250	46911	49572	52059	53743	55541	64367
24	-	-	-	-	-	-	-	44407	46582	48251	49735	52311	54793	57523	59867	62409	64916	67632	72811

All dimensions are in mm

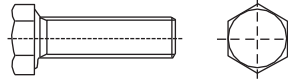

HSN CODE : 73181500

**HEX HEAD BOLT / HEX HEAD SCREW  
DIN 933 / IS : 1364-1992 / ISO 4017****Fully Threaded - A4 70  
Metric - SS 316**

D \ L	110	120	125	130	140	150	160	170	180	200	225
8	6614	7088	7311	7631	8217	8731	-	-	-	-	-
10	10788	11664	12077	12447	13124	13876	15208	-	-	-	-
12	15362	16598	17333	18088	19125	20465	21675	28594	30957	36454	-
16	29750	31886	32923	33946	35820	38485	40938	45019	48600	52726	-
20	49640	52752	54367	56282	59642	63178	66050	69496	72655	79920	116655
24	79442	84738	87429	90295	95514	100756	105923	110899	116366	127108	-

All dimensions are in mm

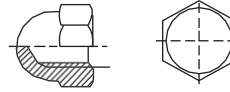

HSN CODE : 73181600

**DOM NUT  
DIN 1587/IS:7790****A4 70  
Metric - SS 316**

SIZE	M 4	M 5	M 6	M 8	M 10	M 12	M 16	M 20	M 24
316	479	546	970	1893	3986	5799	12443	19496	66430

All dimensions are in mm

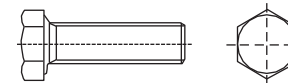

HSN CODE : 73181500

**HEX HEAD BOLT / HEX HEAD SCREW  
BS-1083 / 1965****Fully Threaded - A4  
Inch () - SS 316**

D \ L	1/2"	3/4"	1"	1.1/4"	1.1/2"	2"	2.1/2"	3"	3.1/2"	4"	5"	6"
1/4"	996	1160	1343	1557	1718	2087	2583	2985	3294	3736	-	-
5/16"	1766	2038	2338	2636	2940	3530	4139	4748	5485	6590	-	-
3/8"	2754	3158	3580	4020	4462	5336	6206	7083	7951	8831	11201	13385
1/2"	-	-	7592	8400	9146	10671	12243	13819	15377	16898	19952	22701
5/8"	-	-	13844	14389	15547	18182	20472	23909	25072	27313	33664	38661
3/4"	-	-	-	-	30411	33542	37622	41754	45846	50128	58483	66838

All dimensions are in inches

**HEX NUT  
DIN 934 / IS:1364 P3-2002 / ISO 4032**

HSN CODE : 73181600

**A4 80  
Metric - SS 316**

SIZE	M 2	M 2.5	M 3	M 4	M 5	M 6	M 8	M 10	M 12	M 14	M 16	M 18	M 20	M 22	M 24	M 27	M 30	M 33	M 36
316Q	355	352	136	182	236	412	833	1803	2763	4673	5563	10646	10646	17828	17828	35607	49399	61844	82455

All dimensions are in mm

**HEX NUT  
BS - 1083 / 1965**

HSN CODE : 73181600

**A4  
Inch () - SS 316**

SIZE	1/8"	5/32"	3/16"	1/4"	5/16"	3/8"	7/16"	1/2"	5/8"	3/4"
316Q	296	320	322	642	931	1552	3483	4115	7297	13499

All dimensions are in inches

**TRADE DISCOUNTS AND TAXES APPLY**Visit us at <https://agarwalfasteners.in>

**ALLEN CAP BOLT  
DIN 912 / ISO 4762**

HSN CODE : 73181500

**Fully Threaded - A4 70  
Metric - SS 316**

D	L	6	8	10	12	16	20	25	30	35	40	45	50	60	70	75	80	90	100
3		423	439	450	460	527	585	687	-	-	-	-	-	-	-	-	-	-	-
4		585	590	528	569	641	718	800	999	1135	1315	-	-	-	-	-	-	-	-
5		-	-	745	787	893	996	1144	1306	1517	1747	1932	2117	-	-	-	-	-	-
6		-	-	1072	1102	1227	1334	1467	1650	1798	2080	2294	2436	2960	3297	3613	3963	4581	5426
8		-	-	-	2534	2473	2606	2870	3298	3540	3811	4192	4392	5046	5829	6508	6949	7867	8446
10		-	-	-	-	-	4519	5127	5409	5884	6461	6887	7413	8362	9538	10034	10619	13127	14462
12		-	-	-	-	-	-	8124	8454	9072	9826	10730	11253	12710	13557	14728	15847	17168	18688
16		-	-	-	-	-	-	-	-	18721	20540	22242	23022	25853	28401	30133	32974	36301	39317
20		-	-	-	-	-	-	-	-	-	37195	39416	41994	46516	51175	53878	56166	60722	65309
24		-	-	-	-	-	-	-	-	-	60718	64008	66273	74145	79388	82595	85750	92455	99852

All dimensions are in mm

**HEX THIN NUT / LOCK NUT  
DIN 439 / IS:1364 / ISO : 4035**

HSN CODE : 73181600

**A4 40  
Metric - SS 316**

SIZE	M 5	M 6	M 8	M 10	M 12	M 14	M 16	M 20	M 24
316	300	284	566	1188	1745	3111	3515	7272	13468

All dimensions are in mm

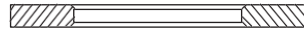
**PLAIN WASHER  
DIN 125/IS:2016-1967/ISO 7089  
A4**

HSN CODE : 73182200

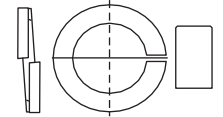
**SPRING WASHER  
DIN 127/IS:3063-1927****A4**

HSN CODE : 73182100

THICK	1.2MM	1.6MM	2MM	2.5MM	3MM	IS
M3 (1/8")	180	-	-	-	-	180
M4 (5/32")	190	-	-	-	-	190
M5 (3/16")	200	220	-	-	-	200
M6 (1/4")	250	300	-	-	-	300
M8 (5/16")	410	450	590	700	720	450
M10 (3/8")	575	790	925	1200	1300	925
M12 (1/2")	875	950	1050	1450	1700	1450
M14 (9/16")	-	1475	1750	1950	2250	2250
M16 (5/8")	1200	1600	1900	2200	2500	2500
M18	-	-	-	-	3200	3200
M20 (3/4")	-	-	-	-	3800	3800
M22 (7/8")	-	-	-	-	4200	4200
M24 (1")	-	-	-	-	5500	7000
M27	-	-	-	-	7000	8200
M30	-	-	-	-	7750	10500
M33	-	-	-	-	11500	14000
M36	-	-	-	-	12500	16500

SIZE	SQUARE	FLAT
M3 (1/8")	175	210
M4 (5/32")	190	225
M5 (3/16")	220	250
M6 (1/4")	290	325
M8 (5/16")	375	525
M10 (3/8")	575	750
M12 (1/2")	850	1300
M14 (9/16")	1100	1550
M16 (5/8")	1400	2350
M18	2000	2900
M20 (3/4")	2450	3750
M22 (7/8")	3300	4600
M24 (1")	4650	6600
M27	5450	7500
M30	7000	11000
M33	12000	15500
M36	16000	17500

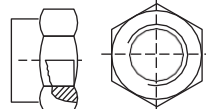
**NYLOCK NUT  
DIN 982 / IS : 7002 - 1972 / ISO 7040**

HSN CODE : 73181600

**A4 80  
Metric - SS 316**

SIZE	M 3	M 4	M 5	M 6	M 8	M 10	M 12	M 16	M 20	M 24
316	300	330	441	677	1231	2382	3553	7994	23145	78576

All dimensions are in mm

**STUD (ONE METER LONG) DIN 975**

HSN CODE : 73181900

**A4 80  
Metric - SS 316**

SIZE	M 4	M 5	M 6	M 8	M 10	M 12	M 14	M 16	M 20	M 24
316	20680	24501	26596	46326	72115	104716	145631	191795	306090	445221

TRADE DISCOUNTS AND TAXES APPLY

Visit us at <https://agarwalfasteners.in>